

C-39-23

John Buckman

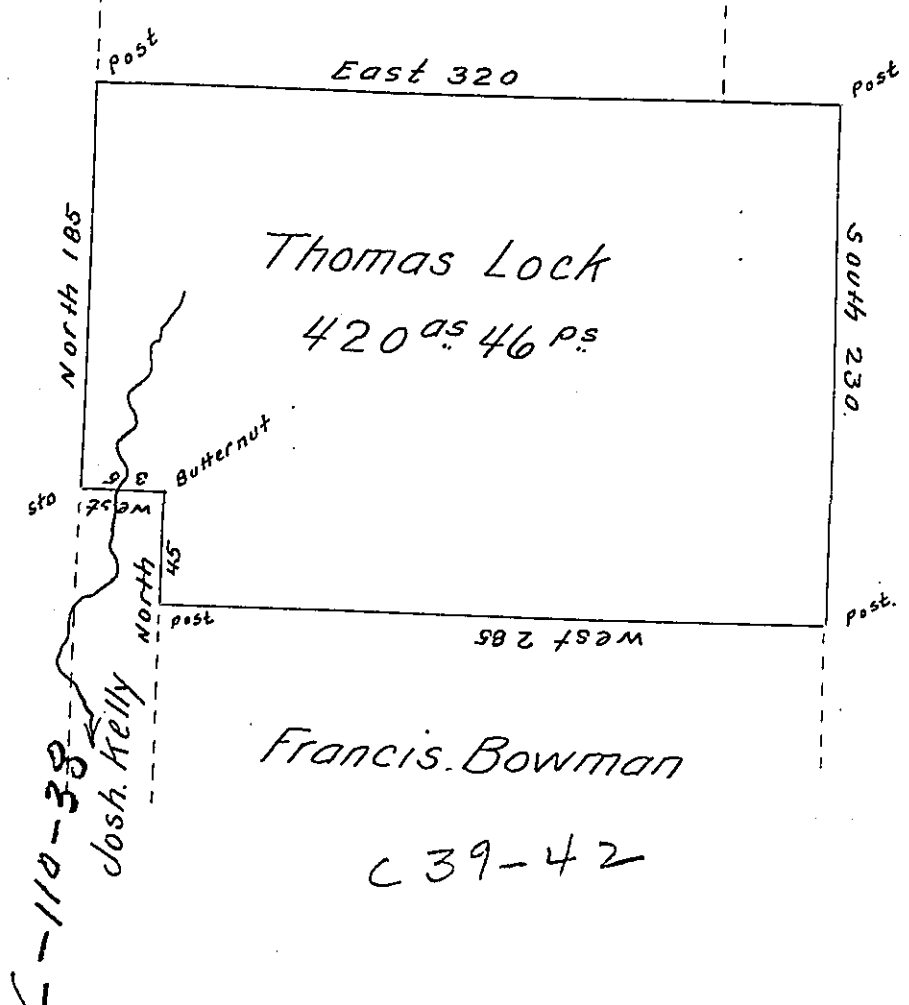

Jas. Bridge

Francis Bowman

C 39-42

Surveyed the above described tract of Land. Containing four hundred twenty acres, forty six perches & Allowance of Six per Ct on the 15th day of August 1857 for Thomas Lock. Situate on the Waters of Bowman's Creek about Seven miles up the Same in the County of Wyoming, by Virtue of his Warrant dated September 3^d 1792.

To John Rowe Esqr
Surveyor General

J. F. Beers Surveyor
for Wyoming Co.

IN TESTIMONY that the above is a copy of the original remaining on file in the Department of Internal Affairs of Pennsylvania, made conformably to an Act of Assembly approved the 16th day of February, 1833, I have hereunto set my Hand and caused the Seal of said Department to be affixed at Harrisburg, this ninth day of October 1905.

[Signature]
Secretary of Internal Affairs.